

Precinct 1

Precinct 2

Precinct 3

Zoning Map

City of Belding, Michigan

Ionia County, Michigan

Legend

- Single Family Residential
- Single Family Residential
- Single Family Residential
- Single and Two Family Residential
- Multiple Family Residential
- Manufactured Home Park
- Office/Service
- Community Business
- General Business
- Industrial
- Parking
- Planned Unit Development



City Planning for
Langworthy LeBlanc, Inc.
Prepared by
FLEIS & VANDENBRINK
PLANNING & ARCHITECTURE

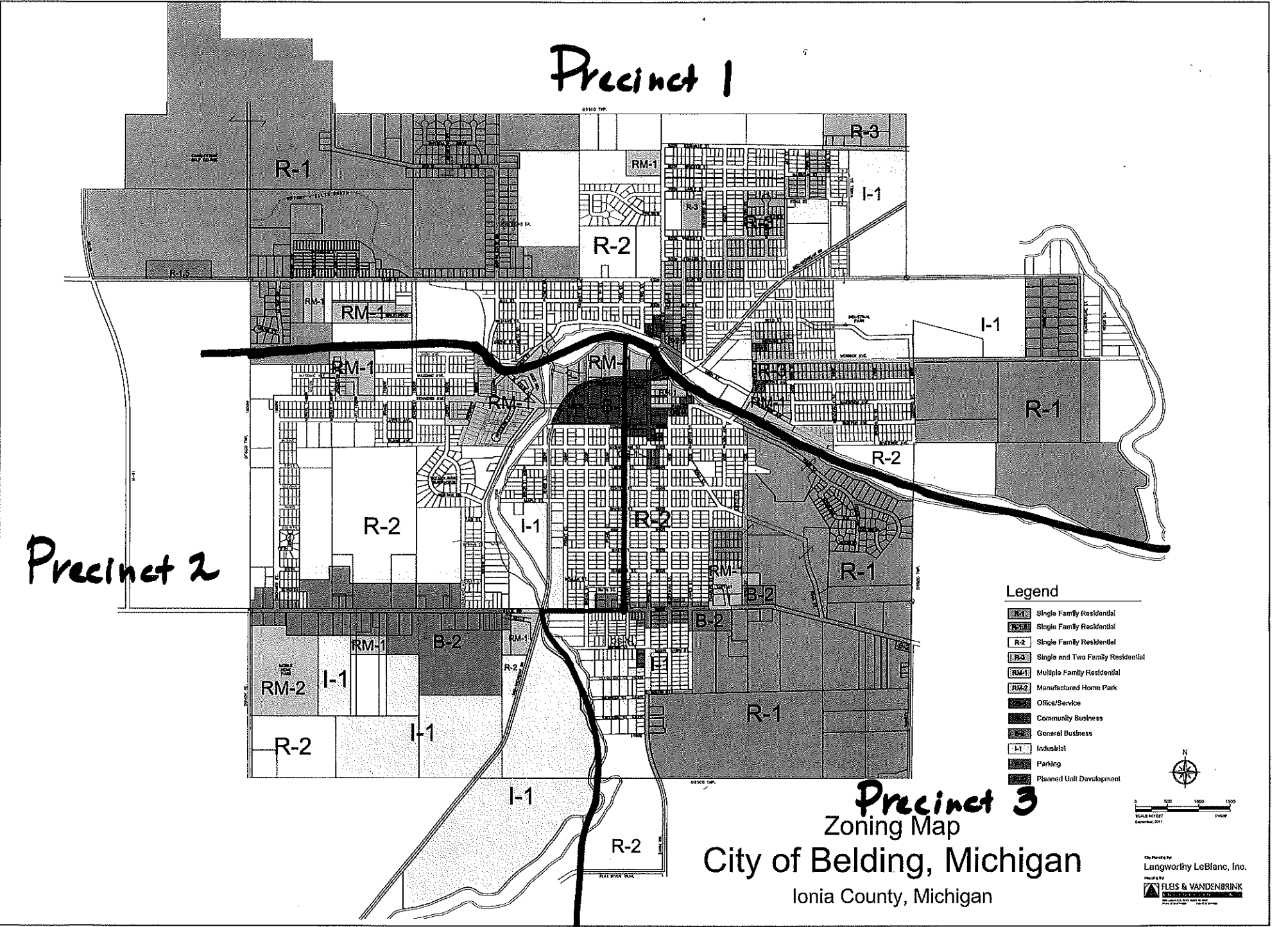

STREET INDEX LISTING

JURISDICTION: BELDING CITY

Date	St. Range-----		Odd/ Ext Range-----		Zip	Precincts-----			Districts-----					Vill	Splits-----			
	Low	High	Even	Low		High	Jurs	Schl	Vill	Con	Hse	Sen	Com		Schl	Con	Hse	Sen
5TH ST, BELDING, 48809																		
02/08/2012	1300	1499	B		48809	00002	00002		03	086	19	01	BELDING AREA SCHO		N	N	N	N
6TH ST, BELDING, 48809																		
02/08/2012	1300	1499	B		48809	00002	00002		03	086	19	01	BELDING AREA SCHO		N	N	N	N
ALDERMAN ST, BELDING, 48809																		
02/08/2012	100	1199	B		48809	00003	00003		03	086	19	01	BELDING AREA SCHO		N	N	N	N
E ANN ST, BELDING, 48809																		
02/08/2012	100	499	B		48809	00003	00003		03	086	19	01	BELDING AREA SCHO		N	N	N	N
W ANN ST, BELDING, 48809																		
02/08/2012	100	398	E		48809	00003	00003		03	086	19	01	BELDING AREA SCHO		N	N	N	N
02/08/2012	101	199	O		48809	00003	00003		03	086	19	01	BELDING AREA SCHO		N	N	N	N
02/08/2012	201	399	O		48809	00002	00002		03	086	19	01	BELDING AREA SCHO		N	N	N	N
ASHFIELD ST, BELDING, 48809																		
02/08/2012	100	499	B		48809	00001	00001		03	086	19	01	BELDING AREA SCHO		N	N	N	N
BALSAM DR, BELDING, 48809																		
02/08/2012	688	766	B		48809	00001	00001		03	086	19	01	BELDING AREA SCHO		N	N	N	N
BELHAVEN ST, BELDING, 48809																		
02/08/2012	1	99	B		48809	00002	00002		03	086	19	01	BELDING AREA SCHO		N	N	N	N
BEULAH ST, BELDING, 48809																		
02/08/2012	400	499	B		48809	00002	00002		03	086	19	01	BELDING AREA SCHO		N	N	N	N
BIG T TRL, BELDING, 48809																		
01/29/2013	696	899	B		48809	00003	00003		03	086	19	01	BELDING AREA SCHO		N	N	N	N
BIRCH ST, BELDING, 48809																		
02/08/2012	400	499	B		48809	00002	00002		03	086	19	01	BELDING AREA SCHO		N	N	N	N
BLAINE ST, BELDING, 48809																		
02/08/2012	900	1199	B		48809	00002	00002		03	086	19	01	BELDING AREA SCHO		N	N	N	N
BRADFORD DR, BELDING, 48809																		
02/08/2012	800	899	B		48809	00001	00001		03	086	19	01	BELDING AREA SCHO		N	N	N	N

STREET INDEX LISTING

JURISDICTION: BELDING CITY

Date	St. Range-----		Odd/ Ext Range-----		Zip	Precincts-----			Districts-----					Splits-----				
	Low	High	Even	Low High		Jurs	Schl	Vill	Con	Hse	Sen	Com	Schl	Vill	Con	Hse	Sen	Com
BRENTWOOD ST, BELDING, 48809																		
02/08/2012	1100	1299	B		48809	00001	00001		03	086	19	01	BELDING AREA SCHO		N	N	N	N
BRICKER ST, BELDING, 48809																		
02/08/2012	100	599	B		48809	00001	00001		03	086	19	01	BELDING AREA SCHO		N	N	N	N
N BRIDGE ST, BELDING, 48809																		
02/08/2012	100	1099	B		48809	00001	00001		03	086	19	01	BELDING AREA SCHO		N	N	N	N
S BRIDGE ST, BELDING, 48809																		
02/08/2012	130	1226	E		48809	00003	00003		03	086	19	01	BELDING AREA SCHO		N	N	N	N
02/08/2012	141	1315	O		48809	00003	00003		03	086	19	01	BELDING AREA SCHO		N	N	N	N
02/08/2012	1323	1599	B		48809	00003	00003		03	086	19	01	BELDING AREA SCHO		N	N	N	N
S BROAS ST, BELDING, 48809																		
02/08/2012	200	999	B		48809	00002	00002		03	086	19	01	BELDING AREA SCHO		N	N	N	N
02/08/2012	1000	1099	B		48809	00003	00003		03	086	19	01	BELDING AREA SCHO		N	N	N	N
BROWN ST, BELDING, 48809																		
02/08/2012	100	399	B		48809	00003	00003		03	086	19	01	BELDING AREA SCHO		N	N	N	N
E CENTER ST, BELDING, 48809																		
02/08/2012	100	699	B		48809	00003	00003		03	086	19	01	BELDING AREA SCHO		N	N	N	N
W CENTER ST, BELDING, 48809																		
02/08/2012	100	498	E		48809	00002	00002		03	086	19	01	BELDING AREA SCHO		N	N	N	N
02/08/2012	101	111	O		48809	00003	00003		03	086	19	01	BELDING AREA SCHO		N	N	N	N
02/08/2012	213	499	O		48809	00002	00002		03	086	19	01	BELDING AREA SCHO		N	N	N	N
CHARLES ST, BELDING, 48809																		
02/08/2012	600	999	B		48809	00003	00003		03	086	19	01	BELDING AREA SCHO		N	N	N	N
E CONGRESS ST, BELDING, 48809																		
02/08/2012	100	499	B		48809	00003	00003		03	086	19	01	BELDING AREA SCHO		N	N	N	N
W CONGRESS ST, BELDING, 48809																		
02/08/2012	100	599	B		48809	00002	00002		03	086	19	01	BELDING AREA SCHO		N	N	N	N
CRAWFORD ST, BELDING, 48809																		
02/08/2012	200	999	B		48809	00001	00001		03	086	19	01	BELDING AREA SCHO		N	N	N	N

STREET INDEX LISTING

JURISDICTION: BELDING CITY

Date	St. Range-----		Odd/ Ext Range-----		Zip	Precincts-----			Districts-----					Splits-----					
	Low	High	Even	Low		High	Jurs	Schl	Vill	Con	Hse	Sen	Com	Schl	Vill	Con	Hse	Sen	Com
CROOKS ST, BELDING, 48809																			
02/08/2012	500	699	B			48809	00001	00001		03	086	19	01	BELDING AREA SCHO		N	N	N	N
N DEMOREST ST, BELDING, 48809																			
02/08/2012	100	499	B			48809	00002	00002		03	086	19	01	BELDING AREA SCHO		N	N	N	N
S DEMOREST ST, BELDING, 48809																			
02/08/2012	100	399	B			48809	00002	00002		03	086	19	01	BELDING AREA SCHO		N	N	N	N
DEODARA DR, BELDING, 48809																			
02/08/2012	507	643	B			48809	00001	00001		03	086	19	01	BELDING AREA SCHO		N	N	N	N
E DIVISION ST, BELDING, 48809																			
02/08/2012	101	499	O			48809	00003	00003		03	086	19	01	BELDING AREA SCHO		N	N	N	N
W DIVISION ST, BELDING, 48809																			
02/08/2012	100	308	E			48809	00002	00002		03	086	19	01	BELDING AREA SCHO		N	N	N	N
02/08/2012	101	127	O			48809	00003	00003		03	086	19	01	BELDING AREA SCHO		N	N	N	N
02/08/2012	129	315	O			48809	00002	00002		03	086	19	01	BELDING AREA SCHO		N	N	N	N
DIVISION , BELDING, 48809																			
02/08/2012	303	309	O			48809	00003	00003		03	086	19	01	BELDING AREA SCHO		N	N	N	N
DUMON RD, BELDING, 48809																			
02/08/2012	6500	6998	E			48809	00002	00002		03	086	19	01	BELDING AREA SCHO		N	N	N	N
EAGER ST, BELDING, 48809																			
02/08/2012	500	599	B			48809	00001	00001		03	086	19	01	BELDING AREA SCHO		N	N	N	N
EARLE ST, BELDING, 48809																			
02/08/2012	100	599	B			48809	00001	00001		03	086	19	01	BELDING AREA SCHO		N	N	N	N
EDGEWOOD ST, BELDING, 48809																			
02/08/2012	600	699	B			48809	00003	00003		03	086	19	01	BELDING AREA SCHO		N	N	N	N
EDNA ST, BELDING, 48809																			
02/08/2012	700	799	B			48809	00001	00001		03	086	19	01	BELDING AREA SCHO		N	N	N	N
ELIZABETH ST, BELDING, 48809																			
02/08/2012	100	499	B			48809	00001	00001		03	086	19	01	BELDING AREA SCHO		N	N	N	N

STREET INDEX LISTING

JURISDICTION: BELDING CITY

Date	St. Range-----		Odd/ Ext Range-----		Zip	Precincts-----			Districts-----					Splits-----					
	Low	High	Even	Low		High	Jurs	Schl	Vill	Con	Hse	Sen	Com	Schl	Vill	Con	Hse	Sen	Com
E ELLIS AVE, BELDING, 48809																			
02/08/2012	100	699	B			48809	00001	00001		03	086	19	01	BELDING AREA SCHO		N	N	N	N
W ELLIS AVE, BELDING, 48809																			
02/08/2012	100	2300	E			48809	00001	00001		03	086	19	01	BELDING AREA SCHO		N	N	N	N
02/08/2012	101	1599	O			48809	00001	00001		03	086	19	01	BELDING AREA SCHO		N	N	N	N
FAIR ST, BELDING, 48809																			
02/08/2012	800	899	B			48809	00002	00002		03	086	19	01	BELDING AREA SCHO		N	N	N	N
FLORAL ST, BELDING, 48809																			
02/08/2012	300	699	B			48809	00003	00003		03	086	19	01	BELDING AREA SCHO		N	N	N	N
N FRONT ST, BELDING, 48809																			
02/08/2012	100	199	B			48809	00002	00002		03	086	19	01	BELDING AREA SCHO		N	N	N	N
S FRONT ST, BELDING, 48809																			
02/08/2012	100	999	B			48809	00002	00002		03	086	19	01	BELDING AREA SCHO		N	N	N	N
GROVE ST, BELDING, 48809																			
02/08/2012	700	799	B			48809	00001	00001		03	086	19	01	BELDING AREA SCHO		N	N	N	N
HALL ST, BELDING, 48809																			
02/08/2012	300	999	B			48809	00003	00003		03	086	19	01	BELDING AREA SCHO		N	N	N	N
HAMBROOK ST, BELDING, 48809																			
02/08/2012	200	699	B			48809	00001	00001		03	086	19	01	BELDING AREA SCHO		N	N	N	N
HANOVER ST, BELDING, 48809																			
02/08/2012	100	399	B			48809	00003	00003		03	086	19	01	BELDING AREA SCHO		N	N	N	N
HARDING ST, BELDING, 48809																			
02/08/2012	500	1099	B			48809	00001	00001		03	086	19	01	BELDING AREA SCHO		N	N	N	N
HARRISON ST, BELDING, 48809																			
02/08/2012	500	899	B			48809	00001	00001		03	086	19	01	BELDING AREA SCHO		N	N	N	N
HARROUN ST, BELDING, 48809																			
02/08/2012	600	899	B			48809	00001	00001		03	086	19	01	BELDING AREA SCHO		N	N	N	N
N HAWLEY HWY, BELDING, 48809																			
01/29/2013	6501	6909	O			48809	00003	00003		03	086	19	01	BELDING AREA SCHO		N	N	N	N

STREET INDEX LISTING

JURISDICTION: BELDING CITY

Date	St. Range-----		Odd/ Ext Range-----		Zip	Precincts-----			Districts-----					Splits-----				
	Low	High	Even	Low		High	Jurs	Schl	Vill	Con	Hse	Sen	Com	Schl	Vill	Con	Hse	Sen
W HIGH ST, BELDING, 48809																		
02/08/2012	100	699	B		48809	00001	00001		03	086	19	01	BELDING AREA SCHO		N	N	N	N
HOWARD ST, BELDING, 48809																		
02/08/2012	500	599	B		48809	00001	00001		03	086	19	01	BELDING AREA SCHO		N	N	N	N
HOWE ST, BELDING, 48809																		
02/08/2012	200	499	B		48809	00001	00001		03	086	19	01	BELDING AREA SCHO		N	N	N	N
02/08/2012	8100	8199	B		48809	00001	00001		03	086	19	01	BELDING AREA SCHO		N	N	N	N
HUMMINGBIRD LN, BELDING, 48809																		
02/08/2012	700	999	B		48809	00003	00003		03	086	19	01	BELDING AREA SCHO		N	N	N	N
I O ST, BELDING, 48809																		
02/08/2012	300	499	B		48809	00001	00001		03	086	19	01	BELDING AREA SCHO		N	N	N	N
IONIA ST, BELDING, 48809																		
02/08/2012	400	559	B		48809	00003	00003		03	086	19	01	BELDING AREA SCHO		N	N	N	N
02/08/2012	900	999	B		48809	00003	00003		03	086	19	01	BELDING AREA SCHO		N	N	N	N
IRVING ST, BELDING, 48809																		
02/08/2012	100	299	B		48809	00002	00002		03	086	19	01	BELDING AREA SCHO		N	N	N	N
E ISABELLE ST, BELDING, 48809																		
02/08/2012	100	298	E		48809	00003	00003		03	086	19	01	BELDING AREA SCHO		N	N	N	N
02/08/2012	101	207	O		48809	00003	00003		03	086	19	01	BELDING AREA SCHO		N	N	N	N
W ISABELLE ST, BELDING, 48809																		
02/08/2012	112	198	E		48809	00003	00003		03	086	19	01	BELDING AREA SCHO		N	N	N	N
02/08/2012	121	399	O		48809	00002	00002		03	086	19	01	BELDING AREA SCHO		N	N	N	N
02/08/2012	200	398	E		48809	00002	00002		03	086	19	01	BELDING AREA SCHO		N	N	N	N
JACKLYN ST, BELDING, 48809																		
02/08/2012	100	1310	B		48809	00002	00002		03	086	19	01	BELDING AREA SCHO		N	N	N	N
JAMES ST, BELDING, 48809																		
02/08/2012	500	1199	B		48809	00003	00003		03	086	19	01	BELDING AREA SCHO		N	N	N	N
JAY ST, BELDING, 48809																		
02/08/2012	700	999	B		48809	00001	00001		03	086	19	01	BELDING AREA SCHO		N	N	N	N

STREET INDEX LISTING

JURISDICTION: BELDING CITY

Date	St. Range-----		Odd/ Ext Range-----		Zip	Precincts-----			Districts-----					Splits-----				
	Low	High	Even	Low High		Jurs	Schl	Vill	Con	Hse	Sen	Com	Schl	Vill	Con	Hse	Sen	Com
KENWOOD AVE, BELDING, 48809																		
02/08/2012	600	1699	B		48809	00002	00002		03	086	19	01	BELDING AREA SCHO		N	N	N	N
KIDDVILLE ST, BELDING, 48809																		
02/08/2012	100	799	B		48809	00001	00001		03	086	19	01	BELDING AREA SCHO		N	N	N	N
LE VAC DR, BELDING, 48809																		
02/08/2012	400	499	B		48809	00001	00001		03	086	19	01	BELDING AREA SCHO		N	N	N	N
LEONARD ST, BELDING, 48809																		
02/08/2012	100	599	B		48809	00001	00001		03	086	19	01	BELDING AREA SCHO		N	N	N	N
N LEROY ST, BELDING, 48809																		
02/08/2012	100	299	B		48809	00002	00002		03	086	19	01	BELDING AREA SCHO		N	N	N	N
S LEROY ST, BELDING, 48809																		
02/08/2012	100	299	B		48809	00002	00002		03	086	19	01	BELDING AREA SCHO		N	N	N	N
LEWIS ST, BELDING, 48809																		
02/08/2012	300	499	B		48809	00001	00001		03	086	19	01	BELDING AREA SCHO		N	N	N	N
E LIBERTY ST, BELDING, 48809																		
02/08/2012	100	299	B		48809	00003	00003		03	086	19	01	BELDING AREA SCHO		N	N	N	N
W LIBERTY ST, BELDING, 48809																		
02/08/2012	100	120	E		48809	00003	00003		03	086	19	01	BELDING AREA SCHO		N	N	N	N
02/08/2012	101	125	O		48809	00003	00003		03	086	19	01	BELDING AREA SCHO		N	N	N	N
02/08/2012	200	799	B		48809	00002	00002		03	086	19	01	BELDING AREA SCHO		N	N	N	N
LINCOLN ST, BELDING, 48809																		
02/08/2012	500	599	B		48809	00001	00001		03	086	19	01	BELDING AREA SCHO		N	N	N	N
LITTLE ST, BELDING, 48809																		
02/08/2012	500	599	B		48809	00003	00003		03	086	19	01	BELDING AREA SCHO		N	N	N	N
LOUVA CT, BELDING, 48809																		
02/08/2012	1500	1599	B		48809	00001	00001		03	086	19	01	BELDING AREA SCHO		N	N	N	N
LUTHER ST, BELDING, 48809																		
02/08/2012	900	1599	B		48809	00002	00002		03	086	19	01	BELDING AREA SCHO		N	N	N	N

STREET INDEX LISTING

JURISDICTION: BELDING CITY

Date	St. Range-----		Odd/ Ext Range-----		Zip	Precincts-----			Districts-----					Splits-----				
	Low	High	Even	Low		High	Jurs	Schl	Vill	Con	Hse	Sen	Com	Schl	Vill	Con	Hse	Sen
E MAIN ST, BELDING, 48809																		
02/08/2012	103	211	O		48809	00003	00003		03	086	19	01	BELDING AREA SCHO		N	N	N	N
W MAPLE ST, BELDING, 48809																		
02/08/2012	500	799	B		48809	00002	00002		03	086	19	01	BELDING AREA SCHO		N	N	N	N
MARTHA ST, BELDING, 48809																		
02/08/2012	801	999	O		48809	00001	00001		03	086	19	01	BELDING AREA SCHO		N	N	N	N
E MARY ST, BELDING, 48809																		
02/08/2012	112	398	E		48809	00003	00003		03	086	19	01	BELDING AREA SCHO		N	N	N	N
W MARY ST, BELDING, 48809																		
02/08/2012	100	498	E		48809	00002	00002		03	086	19	01	BELDING AREA SCHO		N	N	N	N
MASONIC ST, BELDING, 48809																		
02/08/2012	900	1099	B		48809	00002	00002		03	086	19	01	BELDING AREA SCHO		N	N	N	N
E MAY ST, BELDING, 48809																		
02/08/2012	111	609	O		48809	00001	00001		03	086	19	01	BELDING AREA SCHO		N	N	N	N
W MAY ST, BELDING, 48809																		
02/08/2012	100	799	B		48809	00001	00001		03	086	19	01	BELDING AREA SCHO		N	N	N	N
MCKINLEY ST, BELDING, 48809																		
02/08/2012	500	599	B		48809	00001	00001		03	086	19	01	BELDING AREA SCHO		N	N	N	N
MERRICK ST, BELDING, 48809																		
02/08/2012	500	899	B		48809	00001	00001		03	086	19	01	BELDING AREA SCHO		N	N	N	N
02/08/2012	1300	1499	B		48809	00001	00001		03	086	19	01	BELDING AREA SCHO		N	N	N	N
MIDWAY ST, BELDING, 48809																		
02/08/2012	100	299	B		48809	00002	00002		03	086	19	01	BELDING AREA SCHO		N	N	N	N
MILLARD ST, BELDING, 48809																		
02/08/2012	500	799	B		48809	00001	00001		03	086	19	01	BELDING AREA SCHO		N	N	N	N
MORGAN ST, BELDING, 48809																		
02/08/2012	800	899	B		48809	00002	00002		03	086	19	01	BELDING AREA SCHO		N	N	N	N
MORTON AVE, BELDING, 48809																		
02/08/2012	500	899	B		48809	00001	00001		03	086	19	01	BELDING AREA SCHO		N	N	N	N

STREET INDEX LISTING

JURISDICTION: BELDING CITY

Date	St. Range-----		Odd/ Ext Range-----		Zip	Precincts-----			Districts-----					Splits-----				
	Low	High	Even	Low		High	Jurs	Schl	Vill	Con	Hse	Sen	Com	Schl	Vill	Con	Hse	Sen
MORTON ST, BELDING, 48809																		
02/08/2012	491	497	O		48809	00001	00001		03	086	19	01	BELDING AREA SCHO		N	N	N	N
MOULTON ST, BELDING, 48809																		
02/08/2012	500	999	B		48809	00001	00001		03	086	19	01	BELDING AREA SCHO		N	N	N	N
NOBLE DR, BELDING, 48809																		
02/08/2012	687	754	B		48809	00001	00001		03	086	19	01	BELDING AREA SCHO		N	N	N	N
OAKWOOD ST, BELDING, 48809																		
02/08/2012	1200	1499	B		48809	00001	00001		03	086	19	01	BELDING AREA SCHO		N	N	N	N
ORCHARD ST, BELDING, 48809																		
02/08/2012	100	899	B		48809	00002	00002		03	086	19	01	BELDING AREA SCHO		N	N	N	N
PARK ST, BELDING, 48809																		
02/08/2012	600	999	B		48809	00003	00003		03	086	19	01	BELDING AREA SCHO		N	N	N	N
PEARL ST, BELDING, 48809																		
02/08/2012	100	922	E		48809	00002	00002		03	086	19	01	BELDING AREA SCHO		N	N	N	N
02/08/2012	101	919	O		48809	00002	00002		03	086	19	01	BELDING AREA SCHO		N	N	N	N
02/08/2012	921	1099	O		48809	00003	00003		03	086	19	01	BELDING AREA SCHO		N	N	N	N
02/08/2012	924	1098	E		48809	00003	00003		03	086	19	01	BELDING AREA SCHO		N	N	N	N
PINE ST, BELDING, 48809																		
02/08/2012	300	499	B		48809	00001	00001		03	086	19	01	BELDING AREA SCHO		N	N	N	N
PINE MEADOW DR, BELDING, 48809																		
02/08/2012	100	999	B		48809	00001	00001		03	086	19	01	BELDING AREA SCHO		N	N	N	N
PINE RIDGE DR, BELDING, 48809																		
02/08/2012	729	769	B		48809	00001	00001		03	086	19	01	BELDING AREA SCHO		N	N	N	N
PINEVIEW DR, BELDING, 48809																		
02/08/2012	100	621	B		48809	00001	00001		03	086	19	01	BELDING AREA SCHO		N	N	N	N
PLEASANT ST, BELDING, 48809																		
02/08/2012	100	1098	E		48809	00003	00003		03	086	19	01	BELDING AREA SCHO		N	N	N	N
02/08/2012	101	999	O		48809	00002	00002		03	086	19	01	BELDING AREA SCHO		N	N	N	N
02/08/2012	1001	1099	O		48809	00003	00003		03	086	19	01	BELDING AREA SCHO		N	N	N	N

STREET INDEX LISTING

JURISDICTION: BELDING CITY

Date	St. Range-----		Odd/ Ext Range-----		Zip	Precincts-----			Districts-----					Splits-----				
	Low	High	Even	Low High		Jurs	Schl	Vill	Con	Hse	Sen	Com	Schl	Vill	Con	Hse	Sen	Com
N PROSPECT ST, BELDING, 48809																		
02/08/2012	100	299	B		48809	00002	00002		03	086	19	01	BELDING AREA SCHO		N	N	N	N
S PROSPECT ST, BELDING, 48809																		
02/08/2012	100	299	B		48809	00002	00002		03	086	19	01	BELDING AREA SCHO		N	N	N	N
PUTNEY ST, BELDING, 48809																		
02/08/2012	100	499	B		48809	00001	00001		03	086	19	01	BELDING AREA SCHO		N	N	N	N
RANNEY ST, BELDING, 48809																		
02/08/2012	300	499	B		48809	00001	00001		03	086	19	01	BELDING AREA SCHO		N	N	N	N
RIVER ST, BELDING, 48809																		
02/08/2012	300	499	B		48809	00002	00002		03	086	19	01	BELDING AREA SCHO		N	N	N	N
RIVERSIDE ST, BELDING, 48809																		
02/08/2012	500	899	B		48809	00001	00001		03	086	19	01	BELDING AREA SCHO		N	N	N	N
ROOSEVELT ST, BELDING, 48809																		
02/08/2012	500	599	B		48809	00001	00001		03	086	19	01	BELDING AREA SCHO		N	N	N	N
ROOT ST, BELDING, 48809																		
02/08/2012	300	999	B		48809	00001	00001		03	086	19	01	BELDING AREA SCHO		N	N	N	N
RUSSELL DR, BELDING, 48809																		
02/08/2012	800	899	B		48809	00001	00001		03	086	19	01	BELDING AREA SCHO		N	N	N	N
RUTH ST, BELDING, 48809																		
02/08/2012	200	399	B		48809	00002	00002		03	086	19	01	BELDING AREA SCHO		N	N	N	N
SABIN ST, BELDING, 48809																		
02/08/2012	251	251	O		48809	00001	00001		03	086	19	01	BELDING AREA SCHO		N	N	N	N

STREET INDEX LISTING

JURISDICTION: BELDING CITY

Date	St. Range-----		Odd/ Ext Range-----		Zip	Precincts-----			Districts-----					Splits-----				
	Low	High	Even	Low High		Jurs	Schl	Vill	Con	Hse	Sen	Com	Schl	Vill	Con	Hse	Sen	Com
N STATE RD, BELDING, 48809																		
02/08/2012	400	414	E		48809	00001	00001		03	086	19	01	BELDING AREA SCHO		N	N	N	N
02/08/2012	415	521	O		48809	00001	00001		03	086	19	01	BELDING AREA SCHO		N	N	N	N
02/08/2012	500	520	E		48809	00001	00001		03	086	19	01	BELDING AREA SCHO		N	N	N	N
02/08/2012	608	612	E		48809	00001	00001		03	086	19	01	BELDING AREA SCHO		N	N	N	N
02/08/2012	609	621	O		48809	00001	00001		03	086	19	01	BELDING AREA SCHO		N	N	N	N
02/08/2012	701	721	O		48809	00001	00001		03	086	19	01	BELDING AREA SCHO		N	N	N	N
02/08/2012	708	732	E		48809	00001	00001		03	086	19	01	BELDING AREA SCHO		N	N	N	N
02/08/2012	801	851	O		48809	00001	00001		03	086	19	01	BELDING AREA SCHO		N	N	N	N
02/08/2012	820	854	E		48809	00001	00001		03	086	19	01	BELDING AREA SCHO		N	N	N	N
02/08/2012	900	915	B		48809	00001	00001		03	086	19	01	BELDING AREA SCHO		N	N	N	N
02/08/2012	1100	1199	B		48809	00001	00001		03	086	19	01	BELDING AREA SCHO		N	N	N	N
E STATE ST, BELDING, 48809																		
02/08/2012	114	198	E		48809	00003	00003		03	086	19	01	BELDING AREA SCHO		N	N	N	N
02/08/2012	115	121	O		48809	00003	00003		03	086	19	01	BELDING AREA SCHO		N	N	N	N
02/08/2012	201	399	O		48809	00003	00003		03	086	19	01	BELDING AREA SCHO		N	N	N	N
02/08/2012	214	220	E		48809	00003	00003		03	086	19	01	BELDING AREA SCHO		N	N	N	N
02/08/2012	300	302	E		48809	00003	00003		03	086	19	01	BELDING AREA SCHO		N	N	N	N
02/08/2012	400	498	E		48809	00003	00003		03	086	19	01	BELDING AREA SCHO		N	N	N	N
02/08/2012	409	415	O		48809	00003	00003		03	086	19	01	BELDING AREA SCHO		N	N	N	N
02/08/2012	522	698	E		48809	00003	00003		03	086	19	01	BELDING AREA SCHO		N	N	N	N
02/08/2012	701	719	O		48809	00003	00003		03	086	19	01	BELDING AREA SCHO		N	N	N	N
02/08/2012	750	848	E		48809	00003	00003		03	086	19	01	BELDING AREA SCHO		N	N	N	N
02/08/2012	843	847	O		48809	00003	00003		03	086	19	01	BELDING AREA SCHO		N	N	N	N
W STATE ST, BELDING, 48809																		
02/08/2012	100	1598	E		48809	00002	00002		03	086	19	01	BELDING AREA SCHO		N	N	N	N
02/08/2012	101	321	O		48809	00003	00003		03	086	19	01	BELDING AREA SCHO		N	N	N	N
02/08/2012	323	1599	O		48809	00002	00002		03	086	19	01	BELDING AREA SCHO		N	N	N	N
STEPHANIE CT, BELDING, 48809																		
02/08/2012	100	999	B		48809	00001	00001		03	086	19	01	BELDING AREA SCHO		N	N	N	N
STOCKING ST, BELDING, 48809																		
02/08/2012	100	499	B		48809	00003	00003		03	086	19	01	BELDING AREA SCHO		N	N	N	N

STREET INDEX LISTING

JURISDICTION: BELDING CITY

Date	St. Range-----		Odd/ Ext Range-----		Zip	Precincts-----			Districts-----					Splits-----				
	Low	High	Even	Low		High	Jurs	Schl	Vill	Con	Hse	Sen	Com	Schl	Vill	Con	Hse	Sen
TAFT CT, BELDING, 48809																		
02/08/2012	900	999	B		48809	00003	00003		03	086	19	01	BELDING AREA SCHO		N	N	N	N
THOMPSON CT, BELDING, 48809																		
02/08/2012	800	899	B		48809	00001	00001		03	086	19	01	BELDING AREA SCHO		N	N	N	N
THURMAN ST, BELDING, 48809																		
02/08/2012	100	299	B		48809	00003	00003		03	086	19	01	BELDING AREA SCHO		N	N	N	N
VERNAL ST, BELDING, 48809																		
02/08/2012	100	199	B		48809	00002	00002		03	086	19	01	BELDING AREA SCHO		N	N	N	N
02/08/2012	1400	1498	E		48809	00002	00002		03	086	19	01	BELDING AREA SCHO		N	N	N	N
02/08/2012	1501	1501	O		48809	00002	00002		03	086	19	01	BELDING AREA SCHO		N	N	N	N
VINCENT ST, BELDING, 48809																		
02/08/2012	100	599	B		48809	00001	00001		03	086	19	01	BELDING AREA SCHO		N	N	N	N
E WASHINGTON ST, BELDING, 48809																		
02/08/2012	100	499	B		48809	00003	00003		03	086	19	01	BELDING AREA SCHO		N	N	N	N
W WASHINGTON ST, BELDING, 48809																		
02/08/2012	100	122	B		48809	00003	00003		03	086	19	01	BELDING AREA SCHO		N	N	N	N
02/08/2012	123	699	B		48809	00002	00002		03	086	19	01	BELDING AREA SCHO		N	N	N	N
WATER ST, BELDING, 48809																		
02/08/2012	100	999	B		48809	00002	00002		03	086	19	01	BELDING AREA SCHO		N	N	N	N
WELLINGTON EST, BELDING, 48809																		
02/08/2012	1	1599	B		48809	00002	00002		03	086	19	01	BELDING AREA SCHO		N	N	N	N
WHITE PINE CT, BELDING, 48809																		
02/08/2012	342	455	B		48809	00001	00001		03	086	19	01	BELDING AREA SCHO		N	N	N	N
WILDLIFE TRL, BELDING, 48809																		
02/08/2012	800	831	B		48809	00001	00001		03	086	19	01	BELDING AREA SCHO		N	N	N	N
WILLIAMS ST, BELDING, 48809																		
02/08/2012	600	799	B		48809	00001	00001		03	086	19	01	BELDING AREA SCHO		N	N	N	N
WILSON ST, BELDING, 48809																		
02/08/2012	200	399	B		48809	00003	00003		03	086	19	01	BELDING AREA SCHO		N	N	N	N

STREET INDEX LISTING

JURISDICTION: BELDING CITY

Date	St. Range-----		Odd/ Ext Range-----		Zip	Precincts-----			Districts-----					Splits-----				
	Low	High	Even	Low High		Jurs	Schl	Vill	Con	Hse	Sen	Com	Schl	Vill	Con	Hse	Sen	Com
WOODLAND ST, BELDING, 48809																		
02/08/2012	300	599	B		48809	00003	00003		03	086	19	01	BELDING AREA SCHO		N	N	N	N
WOODLOT ST, BELDING, 48809																		
02/08/2012	500	599	B		48809	00003	00003		03	086	19	01	BELDING AREA SCHO		N	N	N	N
N YORK ST, BELDING, 48809																		
02/08/2012	200	999	B		48809	00001	00001		03	086	19	01	BELDING AREA SCHO		N	N	N	N
S YORK ST, BELDING, 48809																		
02/08/2012	100	199	B		48809	00001	00001		03	086	19	01	BELDING AREA SCHO		N	N	N	N

Total 184

Selection Criteria

County: IONIA (34)
 Jurisdiction: BELDING CITY (06900)
 District Type: (ALL)
 District Name: (ALL)
 Street Name: (ALL)
 Changed Since: (ALL)

Report Abbreviations

Jurs Jurisdiction
 Con Congress
 Hse State House
 Sen State Senate
 Com County Commissioner
 Schl School
 Vill Village